

SECURITY WALLS

INSTALLATION

236

CONSTRUCTION DETAILS

237

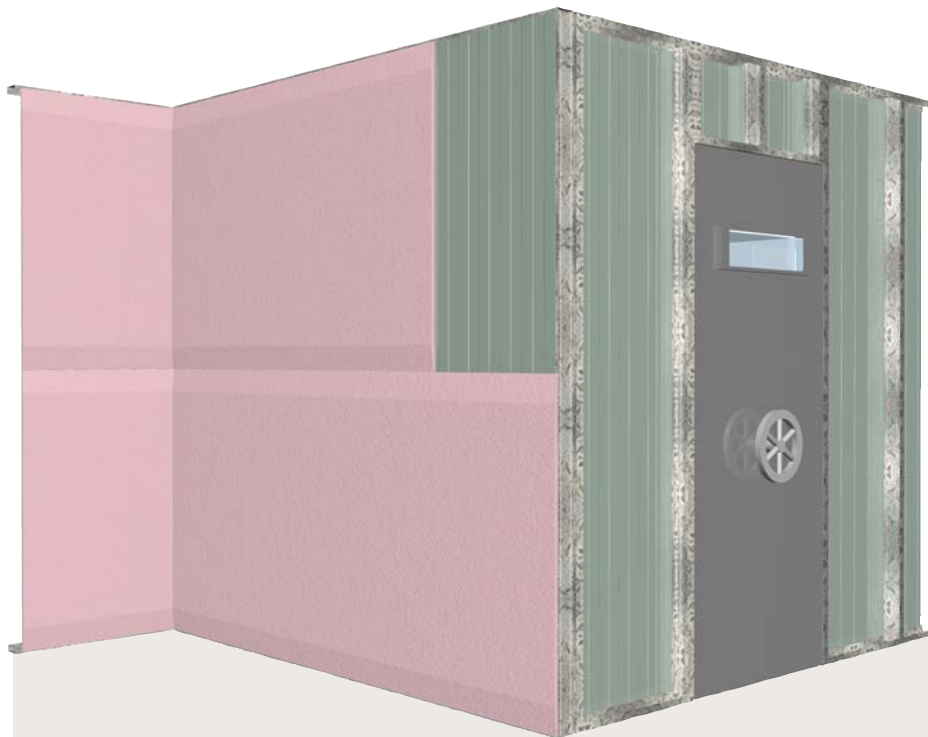

Security wall is an upgrade solution to improve security for any wall system. Applications for security wall can include common walls in multi-residential apartments and hotels, partitioning in shopping centres and retail outlets such as pharmacies.

The system uses a sheet metal barrier that is installed as part of the framing construction. The construction is cost-effective as it allows simple and quick assembly.

The security wall upgrade may be applied to any Lafarge single, staggered or double stud wall system without reducing fire and acoustic performance.

INSTALLATION

[FOR GENERAL REQUIREMENTS, FRAMING, PLASTERBOARD LAYOUT AND PLASTERBOARD FIXING REFER TO SECTION 4.1.1].

Use metal sheeting with a low corrugation profile. This will allow easy fixing to the stud and room for insulation.

Fix metal sheets vertically.

Install additional studs to coincide with corrugations as required. [REFER TO CONSTRUCTION DETAILS].

Cut neat penetrations in the sheet metal panel where access to services is required.

Fix metal sheeting to the studs using screws or rivets at 500mm centres. Keep the flatter side of the sheet metal facing towards the plasterboard.

FIRE RATED AND NON-FIRE RATED SECURITY WALLS

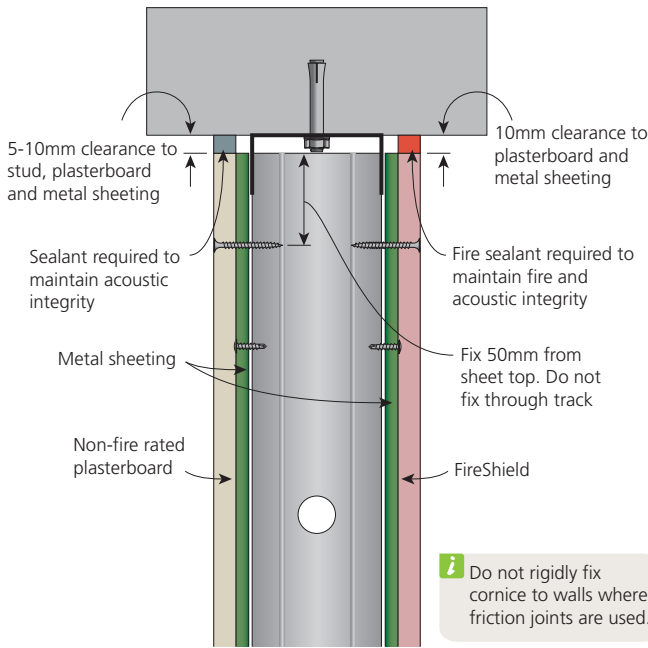

FIGURE 1
Wall head to slab
With metal sheeting - Elevation

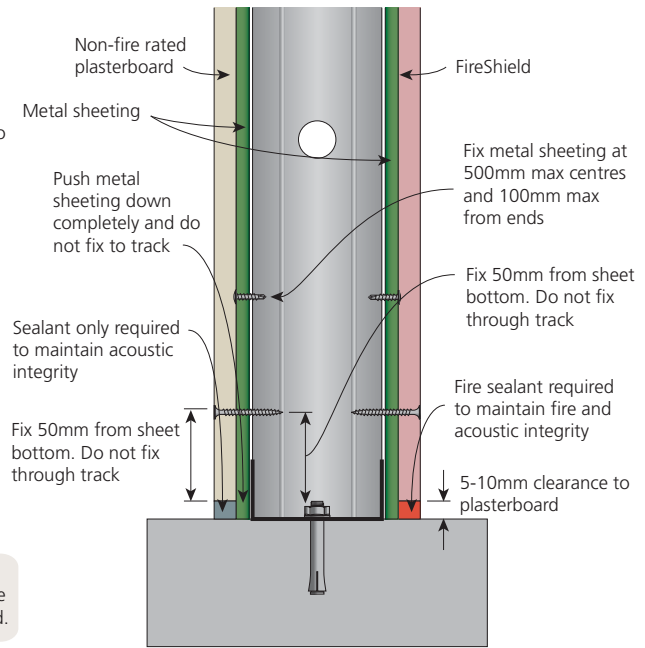

FIGURE 2
Wall base to slab
With metal sheeting - Elevation

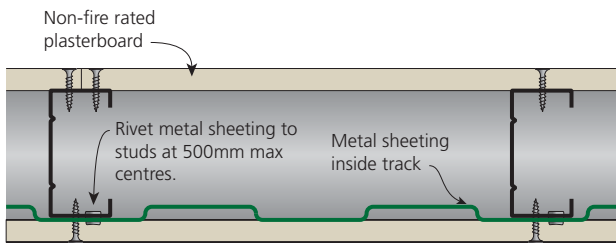

FIGURE 3
Metal sheeting inside track
Plan view

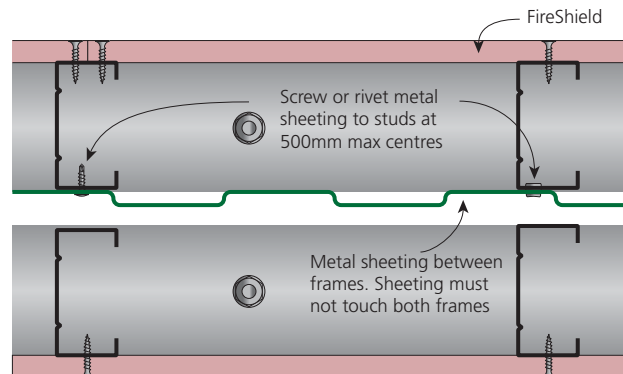

FIGURE 4
Metal sheeting double stud wall
Plan view

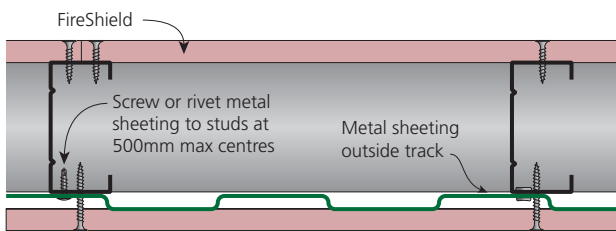

FIGURE 5
Metal sheeting outside track
Plan view

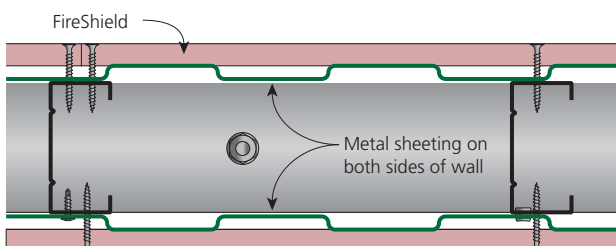

FIGURE 6
Metal sheeting two layers
Plan view

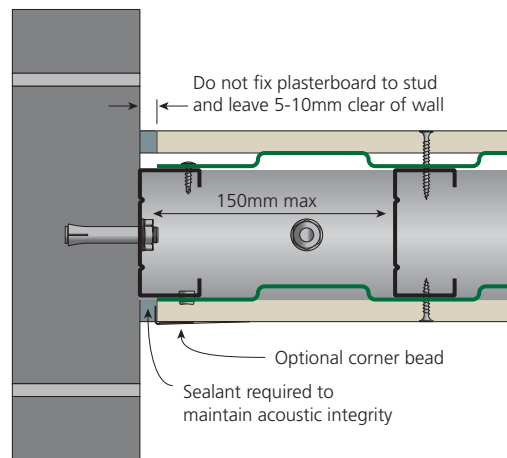

FIGURE 7
Control joint at masonry wall
Plan view

FIRE RATED AND NON-FIRE RATED SECURITY WALLS

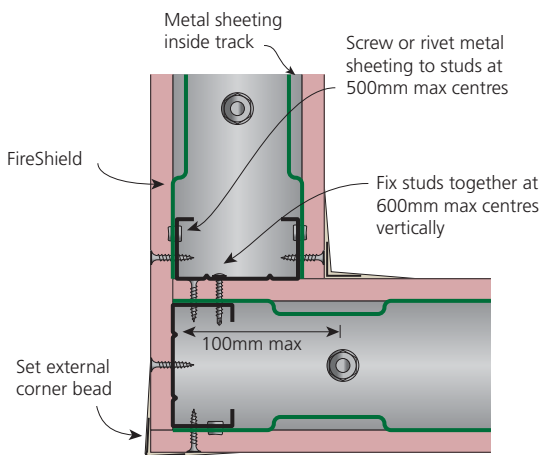

FIGURE 8
Corner detail

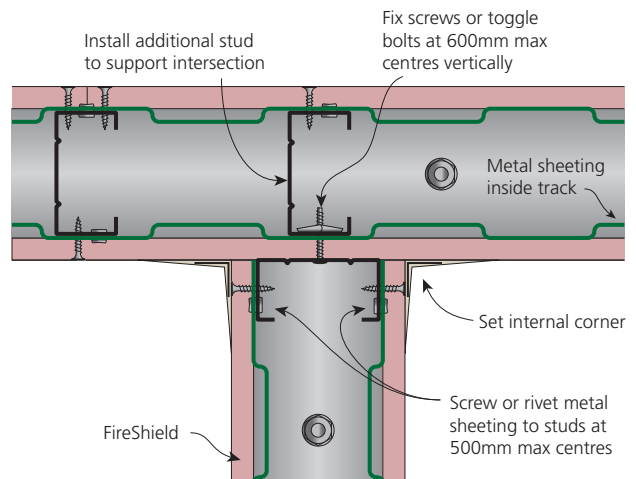

FIGURE 9
Intersecting wall detail

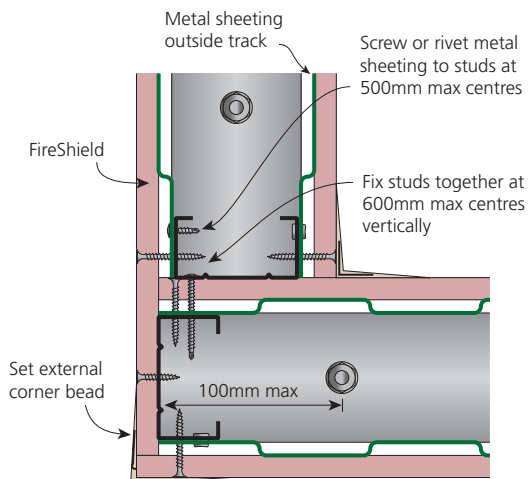

FIGURE 10
Corner detail

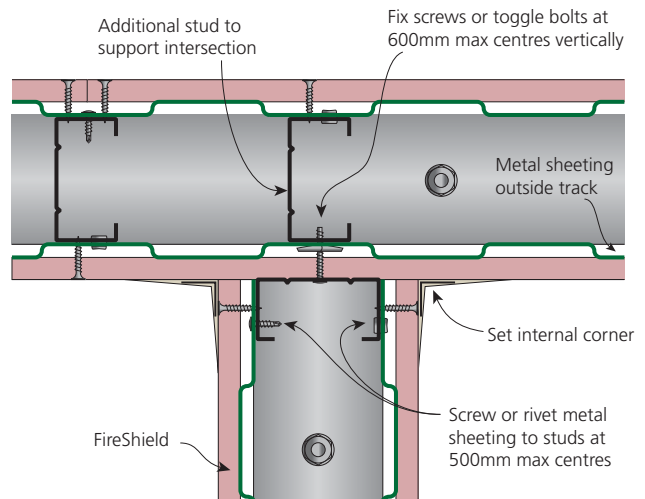

FIGURE 11
Intersecting wall detail

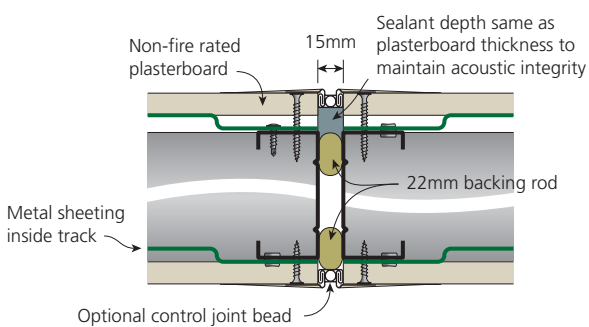

FIGURE 12
Control joint

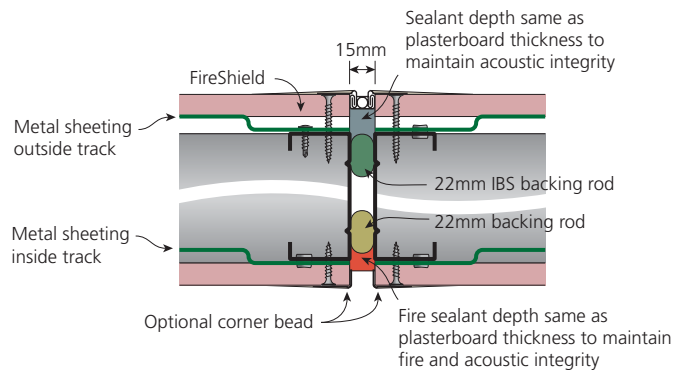

FIGURE 13
Fire rated control joint

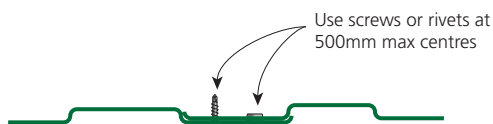

FIGURE 14
Metal sheeting overlap